

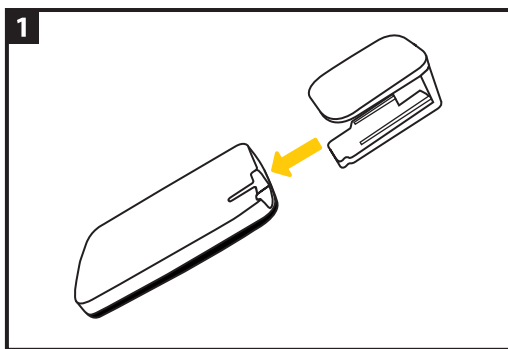

**kapsch** >>>

TRP-4010



1. Attach the bracket to the transponder by sliding it into the slot of the transponder until it clicks in place.

Without removing the bracket adhesive backing, trial fit the transponder at a position behind the rear view mirror, making sure that it will fit and not obstruct the driver's vision.

*Note: If the vehicle model is equipped with a windscreen that contains metal, the transponder shall be placed within the designated, usually dotted, area behind the rear view mirror.*

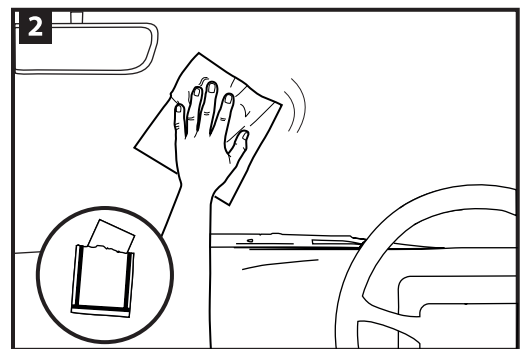

2. Clean the windscreen where the transponder shall be mounted with the cleaning tissue. Make sure that the windscreen is dry and has a temperature of at least 15° C.

If necessary, dry with a cloth or dry and heat the windscreen with the car heater airflow.

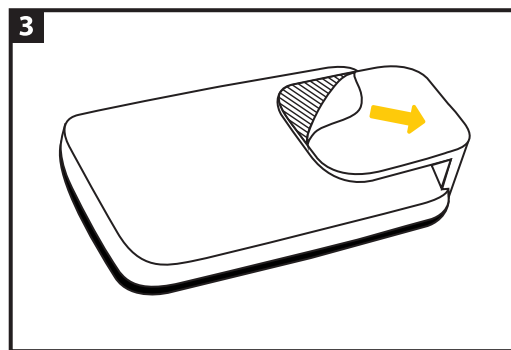

3. Peel off the adhesive backing from the bracket.

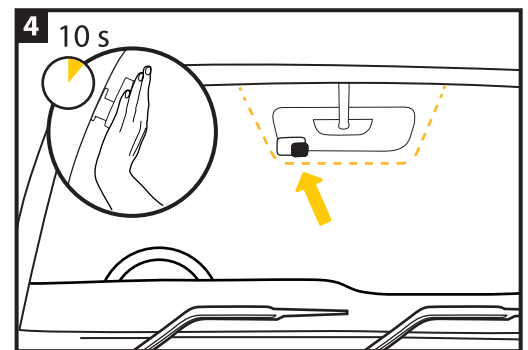

4. Hold the transponder horizontally with the bracket to the left and attach the transponder to the windscreen.

Hold firmly for at least 10 seconds. Leave the transponder in the bracket for at least 24 hours.